

# PROCEDURE FOR USE

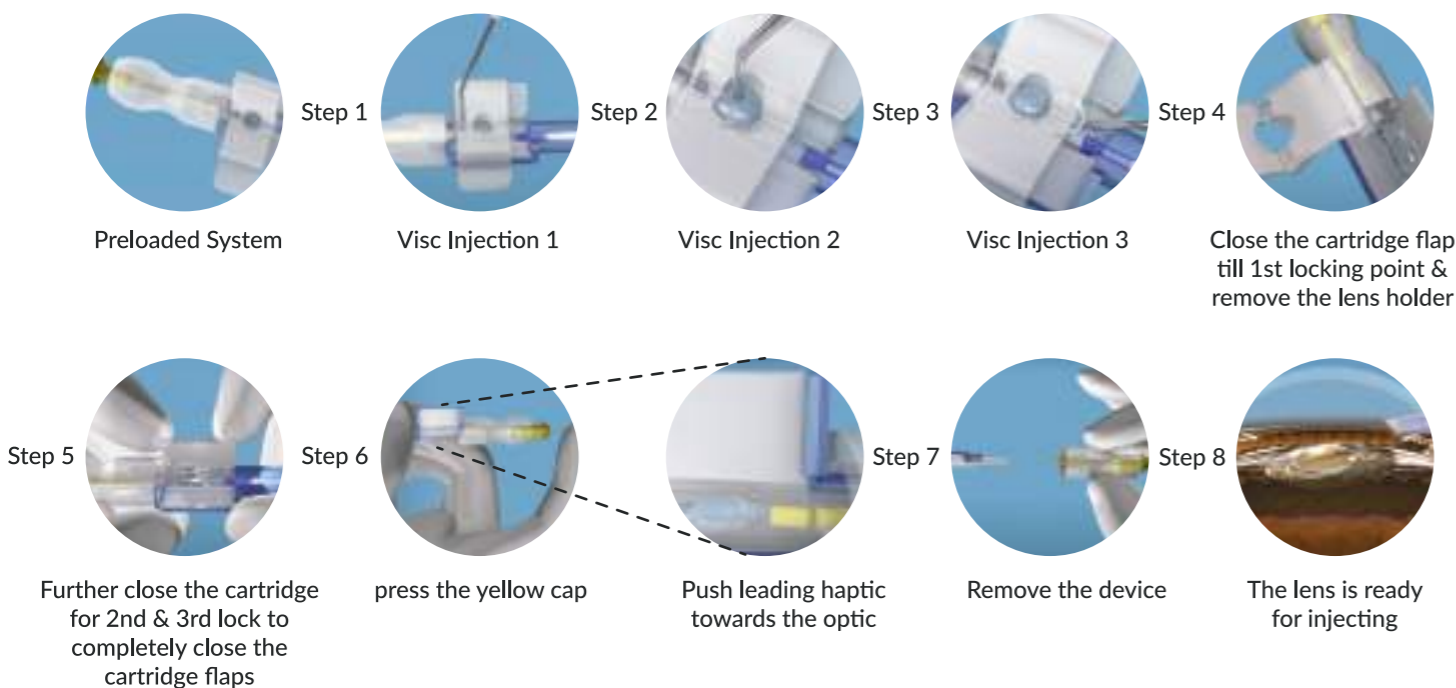

## TECHNICAL SPECIFICATIONS      MODEL: HP760AP

DESIGN CHARACTERISTICS		MATERIAL CHARACTERISTICS	
Optic Design	Aspheric (Negative Aberration)	Lens Material	Hydrophobic Acrylic
Haptics Design	Force Enduring Haptics	10% UV Cut off	385nm
Convexity	Bi-Convex	Light Transmittance	More than 90%
Angulation	3° Angulation	Glass Transition Temperature	8° C
Square Edge	360° Square Edge		
A Constant	118.7 (Optical) 118.4 (Ultra Sound)	Refractive Index	1.47
ACD Value	5mm		
Diopter Range	5.0 to 10.0 in 1.0 D increment 10.0 to 30.0 in 0.5 D increment 30.0 to 35.0 in 1.0 D increment		
Delivery System	Disposal preloaded injector & cartridge for 2.8mm incision (5.0 D to 30.0 D) 3.2mm incision (above 30.0 D)		

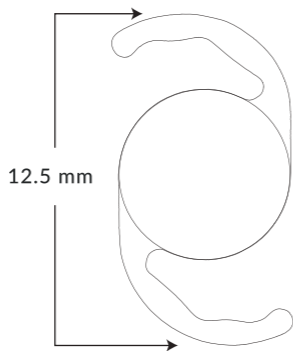

For Hydrophobic IOL Loading Technique



Scan the QR Code

Information published in this catalogue is subject to change without notification

For a demo or more information on how your patients can benefit from Aurolab products, call at **1800 103 7321** or email us at **info@aurolab.com**

### AUROLAB

No.1, Sivagangai Main Road, Veerapanjan, Madurai - 625020, Tamilnadu, India.  
+91 94892 12354 | +91 452 3596100    info@aurolab.com    www.aurolab.com

Issue : 10 - 12/2024

# Aurolab EV Preloaded

Clearer, Brighter, and Enhanced Vision

Hydrophobic Aspheric Acrylic Foldable IOL with  
Negative Aberration Optic



# ENGINEERED FOR CLARITY

Aurolab EV Preloaded IOL enhances everyday vision, mimicking the natural crystalline lens by enhancing depth of focus and contrast sensitivity. With a unique -0.15μ negative aberration design, it provides sharper, clearer vision, even in low-light conditions.

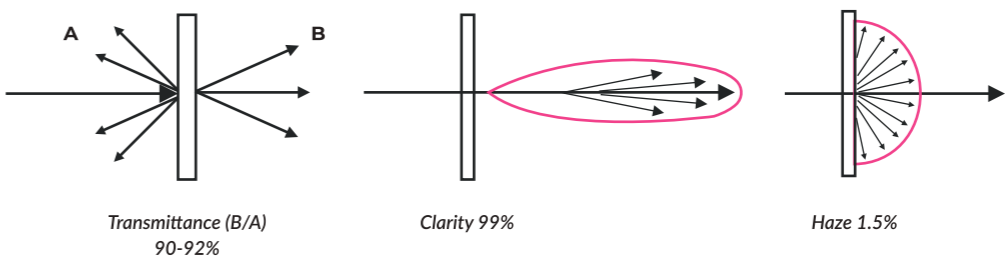

- **Truedge technology:** A 360° square edge acts as a barrier to cell proliferation, minimizing PCO.
- **Advanced 0.1mm projection:** Prevents cell migration at and through the haptic junction.
- **Negative Aspheric optic -0.15 :** Enhances contrast sensitivity and improves vision even in mesopic condition.
- **Glistening free optic:** Facilitates clean vision minimizing reflections.
- **Vault angulation for stability:** Optimized 3 degree vault angulation ensures proper adaptation in the capsular bag.
- **Force enduring haptics for secure lens placement:** Maintains stability and precise positioning.



Simulated image with cataract eye



Simulated image with Zero aberration IOL



Simulated image with Aurovue EV

# INNOVATION IN MATERIAL

A proprietary hydrophobic material technology- Aurovue delivers high optical clarity across all focal distances.

Feature	Aurovue	Market Standards-1	Market Standards-2
Transmittance	92%	91-92%	92%
Clarity	> 99%	NA	NA
Haze	< 1.5%	NA	NA
ABBE Number	55	37	55
Glistening	Nil	NA	Nil
Tg (°C)	8	15	14
Bio Adhesion	High	High	High
Refractive Index	1.47	1.55	1.47

High Abbe number of the material Reduces chromatic aberration, resulting in better colour perception

# PRELOADED FOR PRECISION

The Aurolab EV Preloaded IOL increases safety by saving surgeon time and eliminating loading errors. The lens remains untouched by human hands from production to implantation.

